

MAN  
3

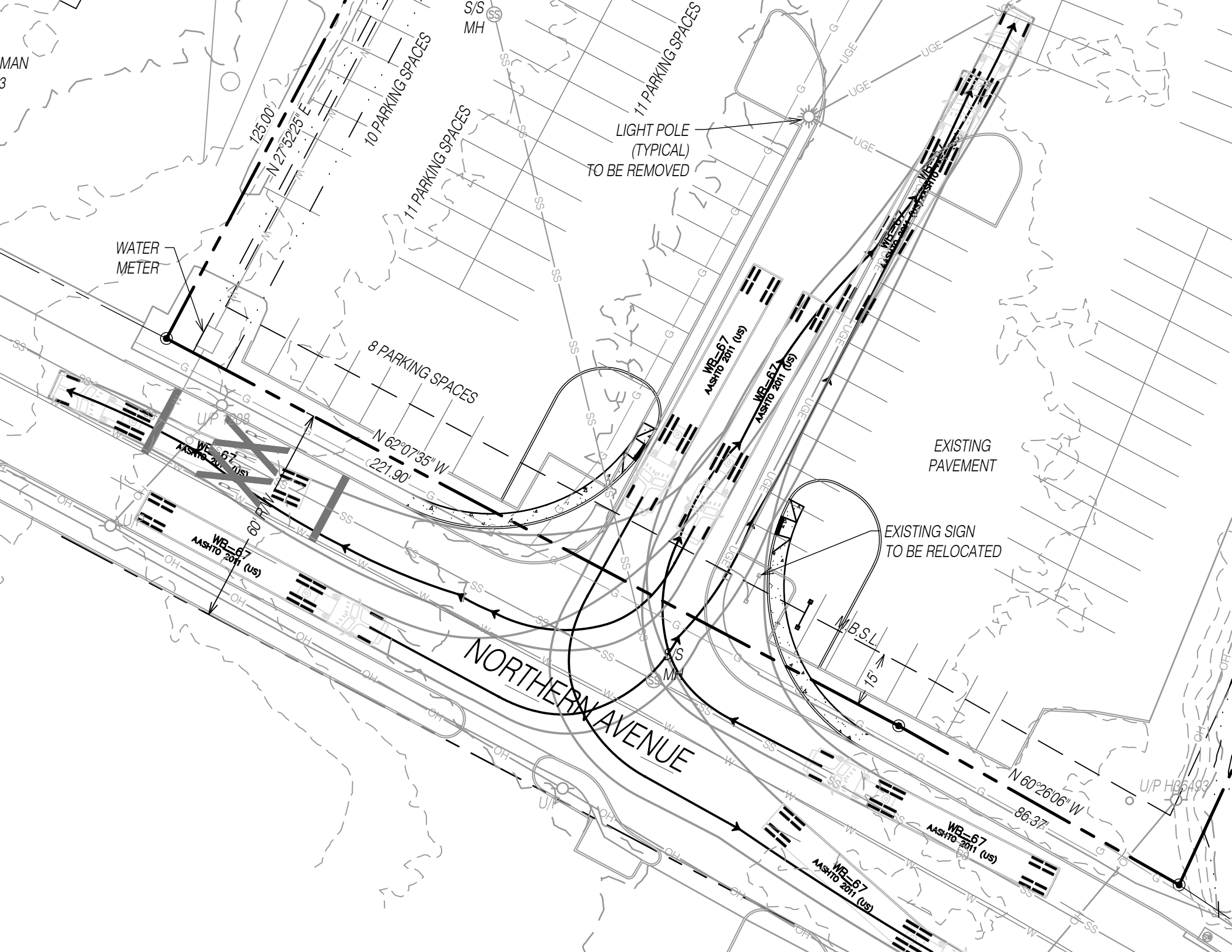

WATER  
METER

LIGHT POLE  
(TYPICAL)  
TO BE REMOVED

EXISTING  
PAVEMENT

EXISTING SIGN  
TO BE RELOCATED

NORTHERN AVENUE

125.00'  
N 27°52'25" E

8 PARKING SPACES

N 62°07'35" W  
221.90'

11 PARKING SPACES

11 PARKING SPACES

11 PARKING SPACES

WB-67  
AASHTO 2011 (US)

WB-67  
AASHTO 2011 (US)

WB-67  
AASHTO 2011 (US)

N.B.S.L.  
75'

N 60°26'06" W  
86.37'

WB-67  
AASHTO 2011 (US)

WB-67  
AASHTO 2011 (US)

U/P H85493